

- 1

Vestibule
- 2

Lobby
- 3

Waiting
- 4

Court
- 5

Judge
- 6

Conference Room
- 7

Admin Staff
- 8

Detention
- 9

Interview
- 10

Break Room
- 11

File
- 12

Server/IT
- 13

Evidence Processing
- 14

Evidence Storage
- 15

Office
- 16

Meeting/Interview Room
- 17

Corporal's Office
- 18

Holding
- 19

Processing
- 20

Sallyport
- 21

Kennel
- 22

Storage
- 23

Armory
- 24

Gear
- 25

Squad Room
- 26

Chief's Office
- 27

Police Reception
- 28

Sewer
- 29

Admin Reception
- 30

Locker Room
- 31

Utility
- 32

Work Area
- 33

Sm. Conference
- 34

Executive Conference
- 35

Janitor's Closet
- 36

Elevator
- 37

High Density Storage
- 38

Toilet Room

PROVIDENCE RD.

FIRST AVE.

COVERED PARKING

TABULATIONS

GROSS SQUARE FOOTAGE

|             |           |
|-------------|-----------|
| FIRST FLOOR |           |
| EXISTING    | 11,888 SF |
| RENOVATED   |           |
| ADDITION    | 4,869 SF  |

|              |          |
|--------------|----------|
| SECOND FLOOR |          |
| ADDITION     | 2,989 SF |

|        |           |
|--------|-----------|
| TOTAL: | 19,746 SF |
|--------|-----------|

|            |             |
|------------|-------------|
| COST       |             |
| RENOVATION | \$3,566,400 |
| ADDITIONS  | \$3,929,000 |

(DEDUCT \$730,000 FOR REDUCED DISTRICT COURT RENOVATION)

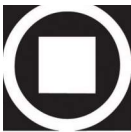

KIMMEL  
BOGRETTE  
ARCHITECTURE

MASTER CONCEPT PLAN  
UPPER PROVIDENCE TOWNSHIP



Upper Providence Township  
DELAWARE COUNTY, PA



FLOOR PLAN CONCEPTS

OPTION I - FIRST FLOOR

August 1, 2025



- 1 Public Meeting
- 2 A/V
- 3 Storage
- 4 Elevator
- 5 Server Room
- 6 Janitor's Closet
- 7 Toilet Room

PROVIDENCE RD.

FIRST AVE.

COVERED PARKING

TABULATIONS

GROSS SQUARE FOOTAGE

|             |           |
|-------------|-----------|
| FIRST FLOOR |           |
| EXISTING    | 11,888 SF |
| RENOVATED   |           |
| ADDITION    | 4,869 SF  |

|              |          |
|--------------|----------|
| SECOND FLOOR |          |
| ADDITION     | 2,989 SF |

|        |           |
|--------|-----------|
| TOTAL: | 19,746 SF |
|--------|-----------|

COST

|            |             |
|------------|-------------|
| RENOVATION | \$3,566,400 |
|------------|-------------|

|           |             |
|-----------|-------------|
| ADDITIONS | \$3,929,000 |
|-----------|-------------|

(DEDUCT \$730,000 FOR REDUCED DISTRICT COURT RENOVATION)

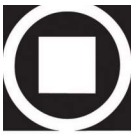

KIMMEL  
BOGRETTE  
ARCHITECTURE

MASTER CONCEPT PLAN  
UPPER PROVIDENCE TOWNSHIP



Upper Providence Township  
DELAWARE COUNTY, PA



Scale: 1" = 40'- 0"



FLOOR PLAN CONCEPTS

OPTION I - SECOND FLOOR

August 1, 2025



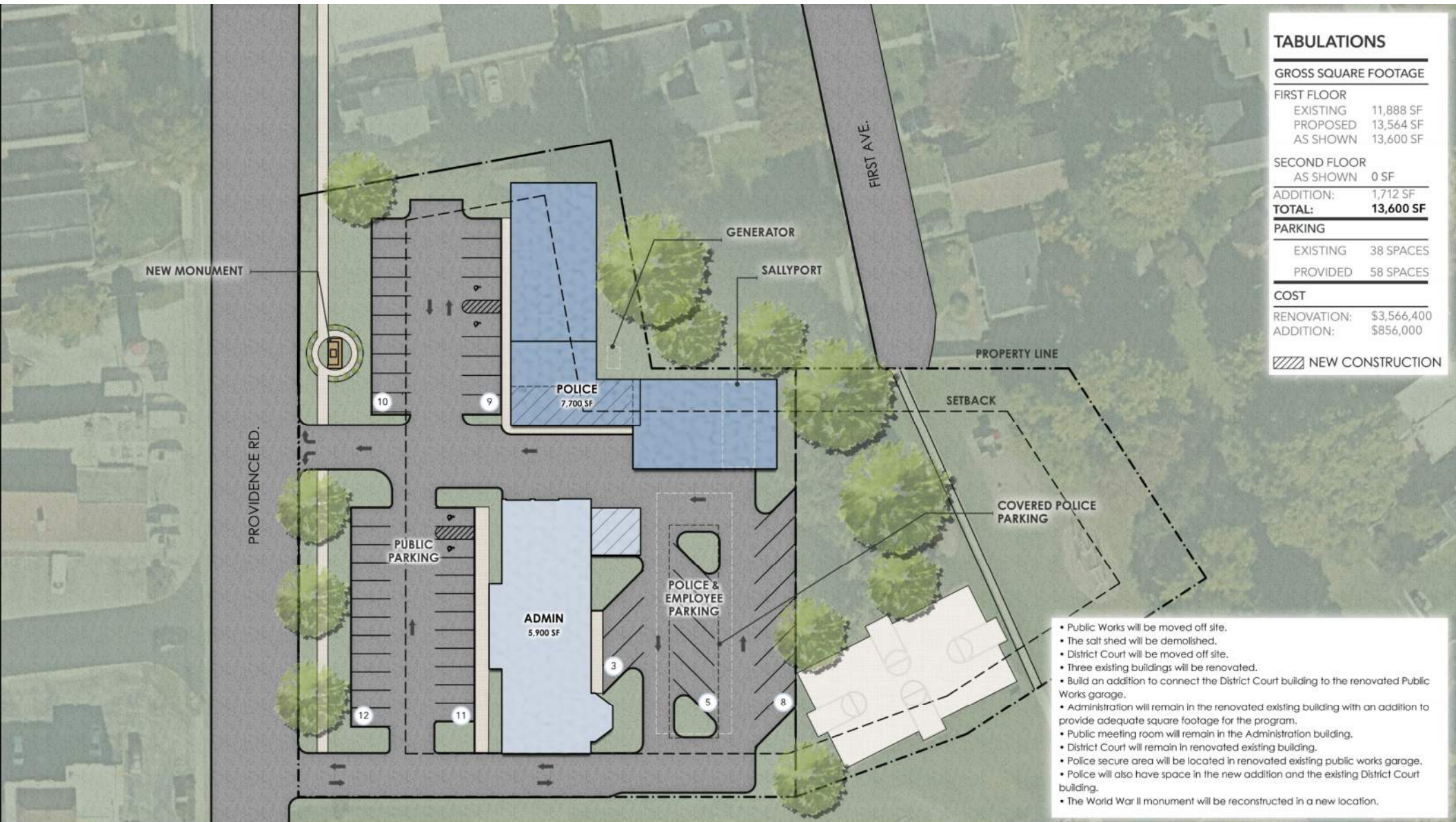

## TABULATIONS

### GROSS SQUARE FOOTAGE

|             |           |  |
|-------------|-----------|--|
| FIRST FLOOR |           |  |
| EXISTING    | 11,888 SF |  |
| PROPOSED    | 13,564 SF |  |
| AS SHOWN    | 13,600 SF |  |

|              |      |  |
|--------------|------|--|
| SECOND FLOOR |      |  |
| AS SHOWN     | 0 SF |  |

|           |          |  |
|-----------|----------|--|
| ADDITION: | 1,712 SF |  |
|-----------|----------|--|

|               |                  |  |
|---------------|------------------|--|
| <b>TOTAL:</b> | <b>13,600 SF</b> |  |
|---------------|------------------|--|

### PARKING

|          |           |
|----------|-----------|
| EXISTING | 38 SPACES |
| PROVIDED | 58 SPACES |

### COST

|             |             |
|-------------|-------------|
| RENOVATION: | \$3,566,400 |
| ADDITION:   | \$856,000   |

NEW CONSTRUCTION

- Public Works will be moved off site.
- The salt shed will be demolished.
- District Court will be moved off site.
- Three existing buildings will be renovated.
- Build an addition to connect the District Court building to the renovated Public Works garage.
- Administration will remain in the renovated existing building with an addition to provide adequate square footage for the program.
- Public meeting room will remain in the Administration building.
- District Court will remain in renovated existing building.
- Police secure area will be located in renovated existing public works garage.
- Police will also have space in the new addition and the existing District Court building.
- The World War II monument will be reconstructed in a new location.



**KIMMEL  
BOGRETTE**  
ARCHITECTURE

MASTER CONCEPT PLAN  
UPPER PROVIDENCE TOWNSHIP



**Upper Providence Township**  
DELAWARE COUNTY, PA

SITE CONCEPTS

OPTION 2  
May 15, 2025

**2**



- 1 Vestibule

2 Lobby

3 Public Meeting

4 Ex. Court to Remain

5 Toilet Room

6 Meeting/Interview Room

7 Training/Break Room

8 File

9 Evidence Processing

10 Office

11 Sallyport

12 Kennel

13 Corporal's Office

14 Police Reception

15 Sewer

16 Admin Reception

17 Locker Room

18 Utility

19 Work Area

20 Executive Conference

21 Police Entry

22 Police Secure

23 Janitor's Closet

24 AV

25 Evidence Storage

26 Armory

27 Squad Room

28 Gear

29 Interview

30 Processing

31 Holding

32 Chief's Office

PROVIDENCE RD.

FIRST AVE.

COVERED PARKING

TABULATIONS

GROSS SQUARE FOOTAGE

|             |          |
|-------------|----------|
| FIRST FLOOR |          |
| EXISTING    | 9,085 SF |
| RENOVATED   |          |
| ADDITION    | 7,847 SF |

|              |      |
|--------------|------|
| SECOND FLOOR |      |
| ADDITION     | 0 SF |

|        |           |
|--------|-----------|
| TOTAL: | 16,932 SF |
|--------|-----------|

|            |             |
|------------|-------------|
| COST       |             |
| RENOVATION | \$1,972,700 |
| ADDITIONS  | \$3,923,500 |

(REDUCED SCOPE IN DISTRICT COURT SAVED \$730,000)

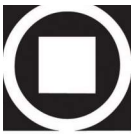

KIMMEL  
BOGRETTE  
ARCHITECTURE

MASTER CONCEPT PLAN  
UPPER PROVIDENCE TOWNSHIP



Upper Providence Township  
DELAWARE COUNTY, PA



FLOOR PLAN CONCEPTS

OPTION 3 - FIRST FLOOR

August 1, 2025



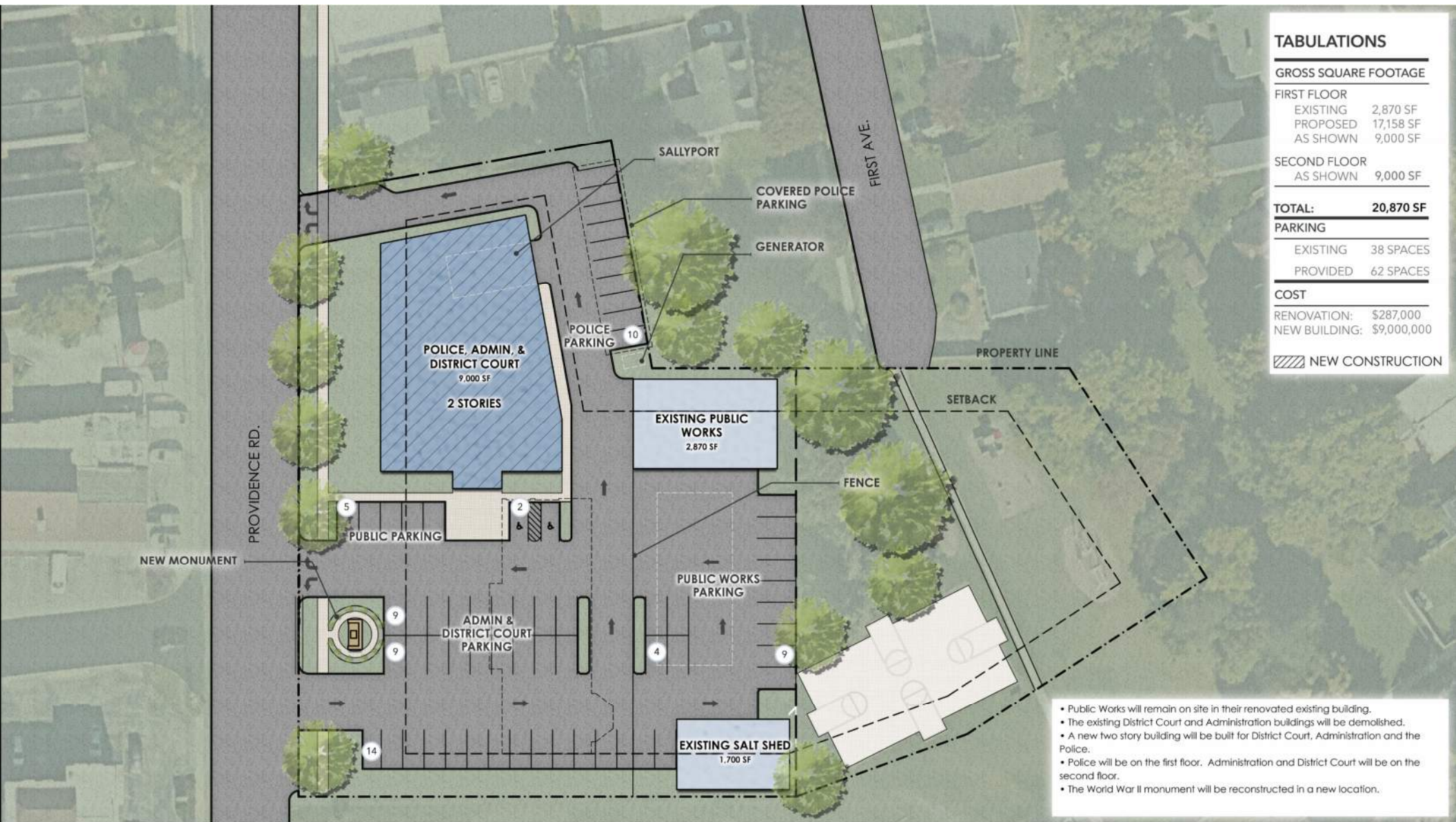

## TABULATIONS

### GROSS SQUARE FOOTAGE

|             |           |
|-------------|-----------|
| FIRST FLOOR |           |
| EXISTING    | 2,870 SF  |
| PROPOSED    | 17,158 SF |
| AS SHOWN    | 9,000 SF  |

|              |          |
|--------------|----------|
| SECOND FLOOR |          |
| AS SHOWN     | 9,000 SF |

**TOTAL: 20,870 SF**

### PARKING

|          |           |
|----------|-----------|
| EXISTING | 38 SPACES |
| PROVIDED | 62 SPACES |

### COST

|               |             |
|---------------|-------------|
| RENOVATION:   | \$287,000   |
| NEW BUILDING: | \$9,000,000 |

NEW CONSTRUCTION

- Public Works will remain on site in their renovated existing building.
- The existing District Court and Administration buildings will be demolished.
- A new two story building will be built for District Court, Administration and the Police.
- Police will be on the first floor. Administration and District Court will be on the second floor.
- The World War II monument will be reconstructed in a new location.



**KIMMEL  
BOGRETTE  
ARCHITECTURE**

MASTER CONCEPT PLAN  
UPPER PROVIDENCE TOWNSHIP



**Upper Providence Township**  
DELAWARE COUNTY, PA

SITE CONCEPTS

OPTION 4

May 15, 2025

**4**



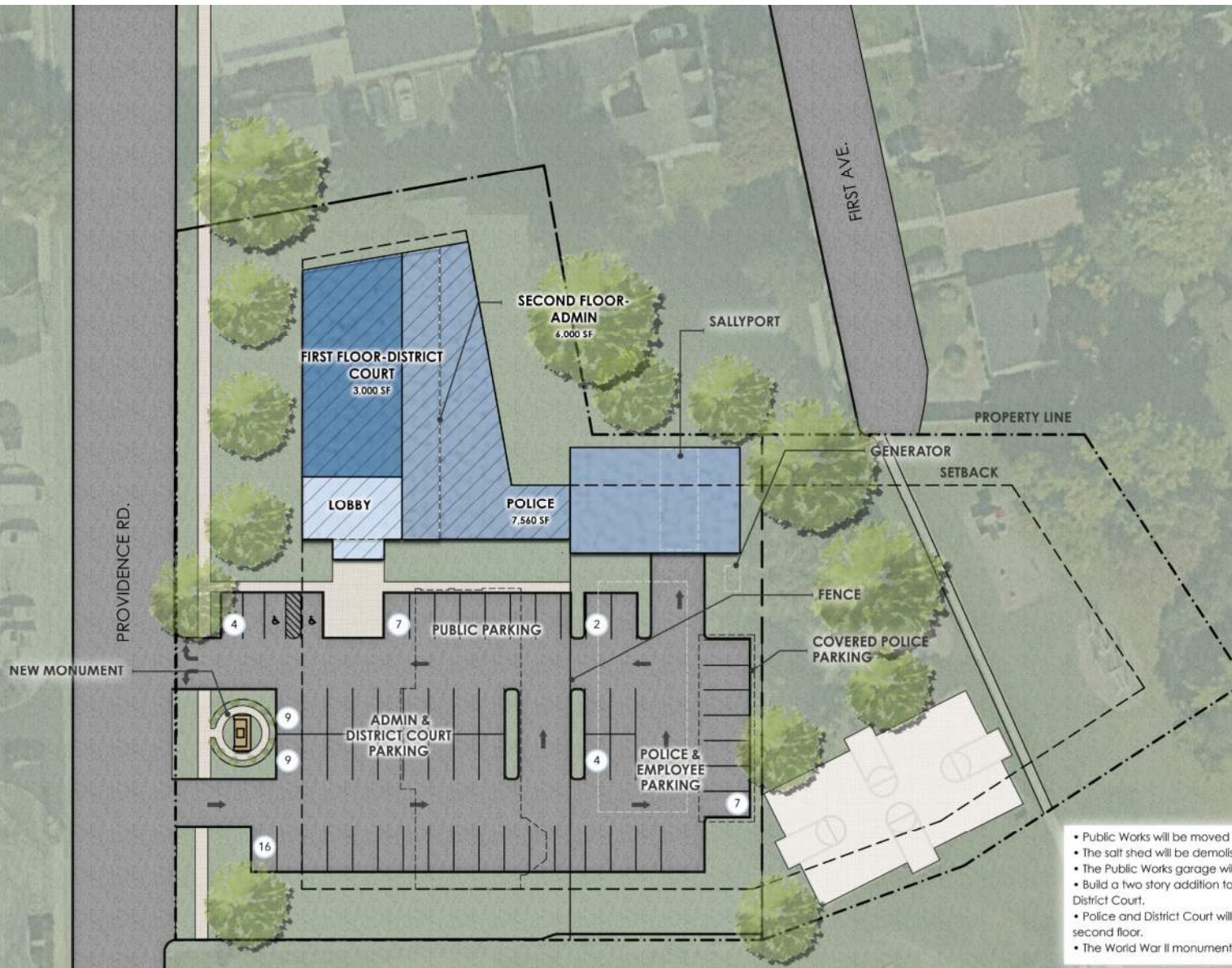

## TABULATIONS

### GROSS SQUARE FOOTAGE

|             |           |
|-------------|-----------|
| FIRST FLOOR |           |
| EXISTING    | 2,870 SF  |
| PROPOSED    | 17,158 SF |
| AS SHOWN    | 11,710 SF |

|              |          |
|--------------|----------|
| SECOND FLOOR |          |
| AS SHOWN     | 6,000 SF |

ADDITION: 14,840 SF

**TOTAL: 17,710 SF**

### PARKING

|          |           |
|----------|-----------|
| EXISTING | 38 SPACES |
| PROVIDED | 58 SPACES |

### COST

|             |             |
|-------------|-------------|
| RENOVATION: | \$861,000   |
| ADDITION:   | \$7,420,000 |

NEW CONSTRUCTION

- Public Works will be moved off site.
- The salt shed will be demolished.
- The Public Works garage will be renovated for Police secure area.
- Build a two story addition to the Garage building for Administration, Police and District Court.
- Police and District Court will be on the first floor, Administration will be on the second floor.
- The World War II monument will be reconstructed in a new location.



Scale: 1" = 40'-0"



**KIMMEL  
BOGRETT  
ARCHITECTURE**

MASTER CONCEPT PLAN  
UPPER PROVIDENCE TOWNSHIP



**Upper Providence Township**  
DELAWARE COUNTY, PA

SITE CONCEPTS

OPTION 5

May 15, 2025

**5**



- 1 Vestibule

2 Lobby

3 Elevator

4 Ex. Court to Remain

5 Toilet Room

6 Meeting/Interview Room

7 Janitor's Closet

8 Locker Room

9 Interview

10 Training/Break Room

11 File

12 Server/IT

13 Evidence Processing

14 Evidence Storage

15 Office

16 Holding

17 Processing
- 18 Sallyport

19 Squad Room

20 Corporal's Office

21 Police Reception

22 Storage

23 Armory

24 Gear

25 Chief's Office

PROVIDENCE RD.

FIRST AVE.

TABULATIONS

GROSS SQUARE FOOTAGE

|             |                  |          |
|-------------|------------------|----------|
| FIRST FLOOR |                  |          |
| EXISTING    | RENOVATED        | 3,660 SF |
|             | NEW CONSTRUCTION | 8,055 SF |

|              |                  |          |
|--------------|------------------|----------|
| SECOND FLOOR |                  |          |
|              | NEW CONSTRUCTION | 8,055 SF |

|          |                  |          |
|----------|------------------|----------|
| BASEMENT |                  |          |
|          | NEW CONSTRUCTION | 1,000 SF |

|        |           |  |
|--------|-----------|--|
| TOTAL: | 20,770 SF |  |
|--------|-----------|--|

|            |  |             |
|------------|--|-------------|
| COST       |  |             |
| RENOVATION |  | \$366,000   |
| ADDITIONS  |  | \$8,255,000 |

(REDUCED SCOPE IN DISTRICT COURT SAVED \$730,000)

COVERED PARKING

BASEMENT MECHANICAL



Scale: 1" = 40'- 0"

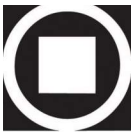

KIMMEL  
BOGRETTE  
ARCHITECTURE

MASTER CONCEPT PLAN  
UPPER PROVIDENCE TOWNSHIP



Upper Providence Township  
DELAWARE COUNTY, PA

FLOOR PLAN CONCEPTS

OPTION 6 - FIRST FLOOR

August 1, 2025



- 1 Lobby

2 Public Meeting

3 A/V

4 Office

5 Manager's Office

6 Small Conference Room

7 File Room

8 Sewer

9 Server

10 Work Area

11 Reception

12 Elevator

13 Janitor's Closet

14 Break Room

15 Mechanical

16 Dead File

17 Copier
- 18 Toilet Room

PROVIDENCE RD.

FIRST AVE.

COVERED PARKING

TABULATIONS

GROSS SQUARE FOOTAGE

|                  |           |          |
|------------------|-----------|----------|
| FIRST FLOOR      |           |          |
| EXISTING         | RENOVATED | 3,660 SF |
| NEW CONSTRUCTION |           | 8,055 SF |

|                  |  |          |
|------------------|--|----------|
| SECOND FLOOR     |  |          |
| NEW CONSTRUCTION |  | 8,055 SF |

|                  |  |          |
|------------------|--|----------|
| BASEMENT         |  |          |
| NEW CONSTRUCTION |  | 1,000 SF |

|        |  |           |
|--------|--|-----------|
| TOTAL: |  | 20,770 SF |
|--------|--|-----------|

|            |  |             |
|------------|--|-------------|
| COST       |  |             |
| RENOVATION |  | \$366,000   |
| ADDITIONS  |  | \$8,255,000 |

(REDUCED SCOPE IN DISTRICT COURT SAVED \$730,000)

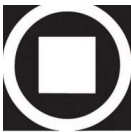

KIMMEL  
BOGRETTE  
ARCHITECTURE

MASTER CONCEPT PLAN  
UPPER PROVIDENCE TOWNSHIP



Upper Providence Township  
DELAWARE COUNTY, PA



Scale: 1" = 40'- 0"



FLOOR PLAN CONCEPTS

OPTION 6 - SECOND FLOOR

August 1, 2025